

■ Portable projection screens



Page
42 - Portalite



43 - LiteScreen
43 - CinemaLite
43 - TableScreen



44 - Picture King
45 - ProStar



46 - Professional
47 - ProView
47 - Mistral



48 - Heavy Duty
FastFold® Deluxe
49 - FastFold®



Features

Lightweight aluminium case with handle.

Set up, pull out and it's ready to use.

Four legs, built into case, can be easily folded in and out (with exception of 50" table-top model).

Table model 50", without legs, for placing on table.

Patented tensioning arm with pneumatic springs facilitates flexible height adjustment and flat projection screen fabric.

Flexible viewing height adjustment via extra black border on the bottom.

Black border increases perceived clarity of projected image.

Options

- ▶ Screen fabrics Matte White S and Datalux S.
- ▶ Formats video (4:3) and HDTV (16:9).

Accessories

- ▶ High quality PortaBag, with handy strap and impact resistant wheels, increases mobility and protects during transport.
10830038 for 50" PortaLite
10830039 for 60" PortaLite
10830040 for 72" PortaLite



▲ **Modern designed portable projection screen available in various sizes and screen fabrics. The perfect solution for flexible use.**

Technical characteristics

- ▶ Projecta products satisfy the strictest quality and safety requirements in Europe and are CE approved.
- ▶ Projecta ensures that the quality of its products are monitored by the TÜV/GS programme.
- ▶ Case (85x105mm) made from blank, anodised aluminium.
- ▶ Matte White S: double-sided laminated vinyl on a woven fiberglass carrier with black backing; gain 1.5 and viewing angle 50° L/R.
- ▶ Datalux S: double-sided laminated vinyl on a woven fiberglass carrier with black backing; high gain 1.5 and viewing angle 35° L/R.
- ▶ Projection screen fabrics satisfy the requirements for fire resistance of construction materials and components.
- ▶ Video (4:3) and HDTV (16:9) format have a 2.5 cm. black border all around plus an extra black border on the bottom.

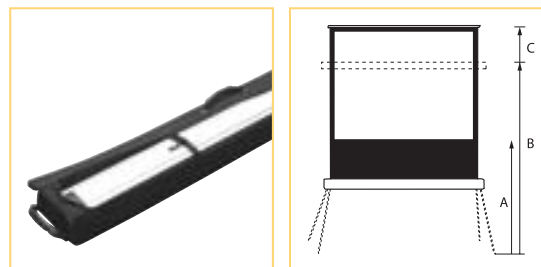

Aspect ratio	Screen size h x w cm	Viewing size h x w cm	Nominal diagonal cm inches	Transport length in cm	Net weight in kg	Screen fabrics		(A) Bottom surface in cm	(B) Min. height in cm	(C) Max. height in cm	Extra border in cm
						Matte White S prod.code	Datalux S prod.code				
4:3	94x107	76x102	127 50	118	7	10400010	10400011	25	89	105	16
	118x131	94x126	152 60	143	8	10400012	10400013	88	165	186	21
	138x151	110x146	183 72	163	9	10400014	10400015	101	190	215	25
16:9	138x151	86x146	165 65	163	9	10400020		129	162	215	53

Features

Tensioning arm with pneumatic springs facilitates flexible height adjustment and flat projection screen fabric.

Flexible viewing height adjustment via extra black border on the bottom.

Black border increases perceived clarity of projected image.



◀ **Lightweight, portable projection screen ready for your onsite professional presentations.**

Technical characteristics

- ▶ Case (100x114mm) of black, anodised aluminium.
- ▶ Besides a black border of 4 cm all around, Video (4:3) and HDTV (16:9) formats also have an extra, black border at the bottom.
- ▶ Datalux F : film with black backing; high gain 2.2 and a 35° L/R viewing angle.

Aspect ratio	Screen size h x w cm	Viewing size h x w cm	Nominal diagonal cm inches		Transport length in cm	Net weight in kg	Screen fabric Datalux F prod.code	(A) Bottom surface in cm	(B) Min. height in cm	(C) Max. height in cm	Extra border in cm
4:3	98x128	90x120	152	60"	141	8	10530154	93	107	180	83
	128x168	120x160	203	80"	181	9	10530157	83	137	210	73
	160x211	152x203	254	100"	242	11	10530168	92	168	250	82
16:9	98x168	90x160	165	65"	181	6	10530192	106	109	204	95
	122x211	114x203	234	92"	242	9	10530193	102	133	224	91

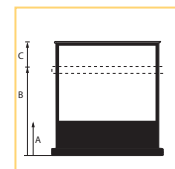

■ CinemaLite

Features

Adjustable viewing height because of telescopic rod and extra black bottom.

Black border increases perceived clarity of projected image.



◀ **Ultra-light portable projection screen in HDTV format is very suitable for Home Cinema use.**

Technical characteristics

- ▶ Case (100x85mm) of charcoal grey anodised aluminium.
- ▶ Datalux F : film with black backing; high gain 2.2 and 35° L/R viewing angle.
- ▶ HDTV-format (16:9) has a black border of 6.5 cm all around plus an extra black border on the lower side.

Aspect ratio	Screen size h x w cm	Viewing size h x w cm	Nominal diagonal cm inches		Transport length in cm	Net weight in kg	Screen fabric Datalux F prod.code	(A) Bottom surface in cm	(B) Min. height in cm	(C) Max. height in cm	Extra border in cm
16:9	88x146	75x133	152	60"	156	4	10530194	71	100	163	63
	112x190	99x177	203	80"	200	5	10530195	70	128	188	60

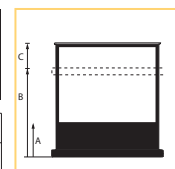

Portable projection screens

■ TableScreen

Features

Tensioning arm with spring guarantees smooth rolling in and out of the projection screen fabric.

Black case/border on fabric increases perceived clarity of projected image.



◀ **Very compact lightweight projection screen for use on table.**

Technical characteristics

- ▶ Case (90x70mm) of black, anodised aluminium.
- ▶ Datalux F : film with black backing; high gain 2.2 and a 35° L/R viewing angle.

Aspect ratio	Screen size h x w cm	Viewing size h x w cm	Nominal diagonal cm inches		Transport length in cm	Net weight in kg	Screen fabric Datalux F prod.code
4:3	61x82	60x80	102	40"	71	1	10530160
	76x102	75x100	127	50"	87	2	10530164

Features

Very stable, square tubular frame with integrated keystone eliminator.

Special transport lock protects the screen fabric from damage.

Black border increases perceived clarity of projected image.

Tripod can be easily and directly folded ready for storage.

Simple, foot-operated toe-release mechanism.

Self locking handle for optimum height adjustment and portability.

Format (1:1 and/or 4:3) directly adjustable via hole design.



Options

- ▶ Screen fabrics Matte White S and High Power.
- ▶ Formats square (1:1) and video (4:3).

▲ **Top quality projection screen on tripod known for it's stability and durability during intensive portable use.**

Technical characteristics

- ▶ Steel, painted, black case (75x75mm).
- ▶ Square, chrome-plated steel tubular frame, keystone eliminator length is 40 cm (with exception of 244 x 244 cm).
- ▶ Matte White S: double-sided laminated vinyl on a woven fiberglass carrier with black backing; gain 1.0 and viewing angle 50° L/R.
- ▶ High Power : double-sided coated vinyl on a woven fiberglass carrier with black backing; high gain 2.8 and viewing angle 25° L/R.
- ▶ Screen fabrics satisfy the requirements for fire resistance of construction materials and components.
- ▶ Square format (1:1) has a 3 cm black border on left/right side.
- ▶ Video format (4:3) has a black border all around.

Accessories

- ▶ Protective cover shields tripod screen from dust during transport.
 10830043 screen width 152 cm
 10830045 screen width 178 cm
 10830046 screen width 213 cm
 10830047 screen width 244 cm

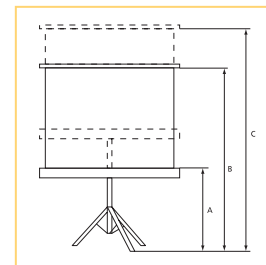

Aspect ratio	Screen size hwxw cm	Viewing size hwxw cm	Nominal diagonal		Transport length in cm	Net weight in kg	Screen fabrics		(A) Bottom viewing surface min. in cm	(B) Min. height in cm	(C) Max. height in cm
			cm	inches			Matte White S prod.code	High Power prod.code			
1:1	152x152	146x146			167	14	10430002	10430021	51	217	282
	178x178	172x172			192	16	10430005	10430022	51	243	325
	213x213	207x207			239	18	10430011		51	278	325
	244x244	238x238			267	20	10430015		51	307	325
4:3	115x152	109x146	183	72	167	13	10430032	10430020	51	174	254
	135x178	127x170	213	84	192	15	10430033	10430023	51	185	300
	162x213	152x203	254	100	239	17	10430035	10430026	51	217	325
	185x244	175x234	305	120	267	19	10430037	10430029	51	239	325

The diagonal sizes listed are approximate in accordance with the market standard. For advice regarding the right size and screen fabric see page 4-6 or consult the Screen Selector at www.projectascreens.com.

Features

Very stable, square tubular frame with integrated keystone eliminator.

Symmetric rotating tripod gives extra stability.

Special transport lock protects the screen fabric from damage.

Black border increases perceived clarity of projected image.

Rotating tripod can be easily and directly folded away ready for storage.

Simple, foot-operated toe-release mechanism.

Self locking handle for optimum height adjustment and portability.

Format (1:1 and/or 4:3) directly adjustable via hole design.

Options

- ▶ Screen fabrics Matte White S and Datalux S.
- ▶ Formats square (1:1) and video (4:3).

Accessories

- ▶ Protective cover shields tripod screen from dust during transport.
10830044 screen width 160 cm
10830045 screen width 180 cm
10830046 screen width 200 cm
10830047 screen width 240 cm



▲ **Top quality, stable and durable projection screen on tripod for intensive portable use.**

Technical characteristics

- ▶ Projecta products satisfy the strictest quality and safety requirements in Europe and are CE approved.
- ▶ Projecta ensures that the quality of its products are monitored by the TÜV/GS programme.
- ▶ Case (68x68mm) made from steel, galvanised interior and dark grey, powder coated exterior (RAL 7021), fitted with impact-resistant plastic end caps.
- ▶ Square, chrome-plated steel tubular frame, keystone eliminator length is 40 cm.
- ▶ Matte White S: double-sided laminated vinyl on a woven fiberglass carrier with black backing; gain 1.5 and viewing angle 50° L/R.
- ▶ Datalux S: double-sided laminated vinyl on a woven fiberglass carrier with black backing; high gain 1.5 and viewing angle 35° L/R.
- ▶ Projection screen fabrics satisfy the requirements for fire resistance of construction materials and components.
- ▶ Square format (1:1) has a 2.5 cm black border on left/right side.
- ▶ Video format (4:3) has a 5 cm black border all around.

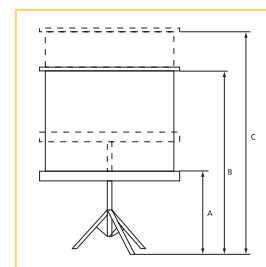

Aspect ratio	Screen size h x w cm	Viewing size h x w cm	Nominal diagonal		Transport length in cm	Net weight in kg	Screen fabrics		(A) Bottom surface in cm	(B) Min. height in cm	(C) Max. height in cm
			cm	inches			Matte White S prod.code	Datalux S prod.code			
1:1	160x160	151x151			168	11	10400054	10400058	55-112	206	263
	180x180	173x173			188	12	10400055	10400059	55-112	228	285
	200x200	195x195			210	14	10400056	10400060	55-112	250	307
	240x240	235x235			250	17	10400057	10400061	55-112	290	347
4:3	123x160	110x146	183	72	168	11	10400062	10400066	55-112	175	232
	138x180	126x168	213	84	188	12	10400063	10400067	55-112	191	248
	153x200	143x190	254	100	210	14	10400064	10400068	55-112	207	265
	183x240	173x230	305	120	250	17	10400065	10400069	55-112	237	295

The diagonal sizes listed are approximate in accordance with the market standard. For advice regarding the right size and screen fabric see page 4-6 or consult the Screen Selector at www.projectascreens.com.

Features

Stable, round tubular frame with integrated keystone eliminator.

Special transport lock protects the screen fabric from damage.

Tripod can be easily and directly folded away ready for storage.

Foot-operated toe-release mechanism.

Easily operated handle for adjustment of height and aspect ratios.

Options

- ▶ Screen fabrics Matte White S and Datalux S.



▲ Professional projection screen on tripod with keystone eliminator.

Technical characteristics

- ▶ Projecta products satisfy the strictest quality and safety requirements in Europe and are CE approved.
- ▶ Projecta ensures that the quality of its products are monitored by the TÜV/GS programme.
- ▶ Case (68x68mm) made from steel, galvanised interior and dark grey, powder coated exterior (RAL 7021), fitted with impact resistant plastic end caps.
- ▶ Round, chrome-plated steel tubular frame, keystone eliminator length is 30 cm.
- ▶ Matte White S: double-sided laminated vinyl on a woven fiberglass carrier with black backing; gain 1.5 and viewing angle 50° L/R.
- ▶ Datalux S: double-sided laminated vinyl on a woven fiberglass carrier with black backing; high gain 1.5 and viewing angle 35° L/R.
- ▶ Projection screen fabrics satisfy the requirements for fire resistance of construction materials and components.
- ▶ Square format (1:1) has a 2.5 cm black border on left/right side.

Accessories

- ▶ Protective cover shields tripod screen from dust during transport.
10830043 screen width 145 cm
10830044 screen width 160 cm
10830045 screen width 180 cm
10830046 screen width 200 cm

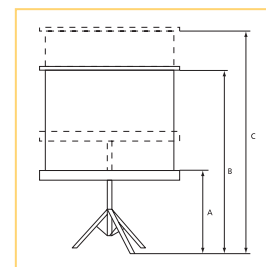

Aspect ratio	Screen size h x w cm	Viewing size h x w cm	Transport length in cm	Net weight in kg	Screen fabrics		(A) Bottom surface in cm	(B) Min. height in cm	(C) Max. height in cm
					Matte White S prod.code	Datalux S prod.code			
1:1	145x145	140x140	155	10	10400044	10400043	62-97	202	237
	160x160	151x151	168	11	10400046	10400045	62-114	213	265
	180x180	173x173	188	12	10400048	10400047	62-132	235	305
	200x200	195x195	210	14	10400052	10400053	62-110	257	305

ProView



▲ Projection screen on tripod with keystone eliminator.

Features

Stable, round tubular frame with integrated keystone eliminator.

Easily operated handle for adjustment of height and aspect ratios.

Accessories

- ▶ Protective cover shields tripod screen from dust during transport.
10830043 screen width 125 cm
10830043 screen width 145 cm
10830044 screen width 160 cm
10830045 screen width 180 cm



Technical characteristics

- ▶ Projecta products satisfy the strictest quality and safety requirements in Europe and are CE approved.
- ▶ Projecta ensures that the quality of its products are monitored by the TÜV/GS programme.
- ▶ Case (68x68mm) made from steel, galvanised interior and dark grey powder coated exterior (RAL 7021), fitted with impact resistant plastic end caps.
- ▶ Round, chrome-plated steel tubular frame, keystone eliminator length is 20 cm.
- ▶ Matte White S: double-sided laminated vinyl on a woven fiberglass carrier with black backing; gain 1.0 and viewing angle 50° L/R.
- ▶ Projection screen fabrics satisfy the requirements for fire resistance of construction materials and components.
- ▶ Square format (1:1) has a 2.5 cm black border on left/right side.

Mistral



▲ Projection screen on tripod.

Features

Stable, round tubular frame with tripod.

Easily operated handle for adjustment of height and aspect ratios.

Accessories

- ▶ Protective cover shields tripod screen from dust during transport.
10830043 screen width 125 cm
10830043 screen width 145 cm



Technical characteristics

- ▶ Projecta products satisfy the strictest quality and safety requirements in Europe and are CE approved.
- ▶ Projecta ensures that the quality of its products are monitored by the TÜV/GS programme.
- ▶ Case (68x68mm) made from steel, galvanised interior and dark grey, powder coated exterior (RAL 7021), fitted with impact-resistant plastic end caps.
- ▶ Round, chrome-plated steel tubular frame.
- ▶ Matte White S: double-sided laminated vinyl on a woven fiberglass carrier with black backing; gain 1.0 and viewing angle 50° L/R.
- ▶ Projection screen fabrics satisfy the requirements for fire resistance of construction materials and components.
- ▶ Square format (1:1) has a 2.5 cm black border on left/right side.

Product	Aspect ratio	Screen size hwxw cm	Viewing size hwxw cm	Transport length in cm	Net weight in kg	Screen fabric Matte White S prod.code	(A) Bottom surface in cm	(B) Min. height in cm	(C) Max. height in cm
ProView	1:1	125x125	120x120	135	7	10400070	39-77	159	197
		145x145	140x140	155	8	10400073	39-97	179	237
		160x160	151x151	168	9	10400076	39-114	190	265
		180x180	173x173	188	11	10400083	39-132	212	305
Product	Aspect ratio	Screen size hwxw cm	Viewing size hwxw cm	Transport length in cm	Net weight in kg	Screen fabric Matte White S prod.code	(A) Bottom surface in cm	(B) Min. height in cm	(C) Max. height in cm
Mistral	1:1	125x125	120x120	135	6	10400003	39-77	159	197
		145x145	140x140	155	7	10400005	39-97	179	237

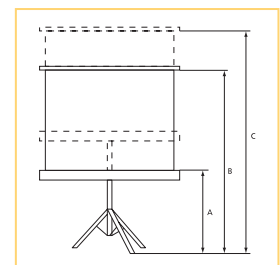

■ Heavy Duty Fast-Fold® Deluxe

Features

Folding frame, two separate legs and separate projection screen fabric.

For use at any desired location, inside and outside.

Legs with side supports for extra stability.

Aluminium frame with projection screen fabric secured with snaps at front.

Black border (15 cm wide) all around increases perceived clarity of projected image.

Folding frame is easily set up without tools.

Frame height is adjustable to desired viewing height.

Supplied in two robust plastic transport cases on wheels.

Options

- ▶ Screen fabrics Matte White D and Da-Tex rear projection screen fabric.

Accessories

- ▶ Matte White D projection screen fabric or Da-Tex rear projection screen fabric including protective cover are available separately.
- ▶ Separately available: fire retardant cotton velour drapery attached with snaps to Fast-Fold® screens to enhance image and project a professional appearance.

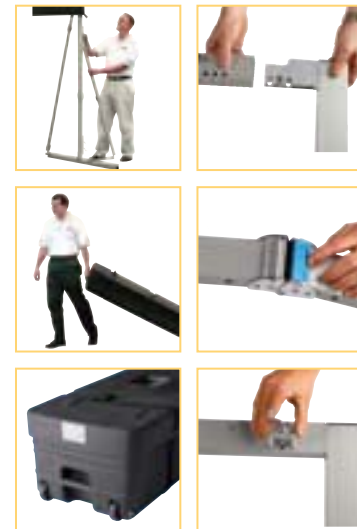

- ▶ **Portable, very solid tensioned screen (widths starting at 457 cm) for use at large events.**

Technical characteristics

- ▶ Aluminium, anodised frame (64x32mm) with handy hinges and telescopic corners forms light yet sturdy construction for frame and legs.
- ▶ Height adjustable in increments of 15 cm, starting at 5 cm.
- ▶ Frame > 7 metres wide fitted with extra strengthening brackets.
- ▶ Matte White D: vinyl film; gain 1.0 and viewing angle 50° L/R. Seamless until 4.8 m wide.
- ▶ Da-Tex rear projection screen fabric: translucent, grey vinyl; gain 1.8 and viewing angle 30° L/R. Seamless until 4.8 m wide.
- ▶ Projection screen fabrics satisfy the requirements for fire resistance of construction materials and components.

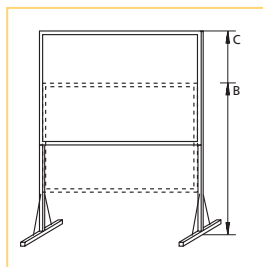

Aspect ratio	Screen size h x w cm	Viewing size h x w cm	Nominal diagonal		Net weight in kg	Screen fabrics		(B) Min. height in cm	(C) Max. height in cm	Separate Screen fabrics	
			cm	feet		Matte White D prod.code	Da-Tex prod.code			Matwit D prod.code	Da-Tex prod.code
4:3	350x457	320x427	457	14	50	10530110	10530111	355	595	10530041	10530033
	396x518	366x488	610	16	55	10530106	10530107	401	678	10530038	10530034
	488x640	458x610	762	20	69	10530104	10530108	493	784	10530031	10530035
	579x762	549x732	915	21	83	10530105	10530109	584	950	10530039	10530036

The diagonal sizes listed are approximate in accordance with the market standard. For advice regarding the right size and screen fabric see page 4-6 or consult the Screen Selector at www.projectascreens.com.

Features

Folding frame, two separate legs and separate projection screen fabric.

For use at any desired location, inside and outside.

Aluminium frame with projection screen fabric secured with snaps at front.

Black border (5 cm wide) all around increases perceived clarity of projected image.

Lightweight, folding frame is easily set up without tools.

Frame height is adjustable to desired viewing height.

Supplied in robust plastic transport case on wheels.

Options

- ▶ Screen fabrics Matte White D and rear projection screen fabric Da-Tex.
- ▶ Formats square (1:1), slide (3:2), video (4:3) and HDTV (16:9).

Accessories

- ▶ Matte White D projection screen fabric or Da-Tex rear projection screen fabric including protective cover are available separately.
- ▶ Separately available: fire retardant cotton velour drapery attached with snaps to Fast-Fold® screens to enhance image and project a professional appearance.



▲ Portable, easily set up tensioned screen (widths up to 427 cm) for use at any desired location.

Technical characteristics

- ▶ Aluminium, anodised tubular frame (32x32mm) with handy hinges and corner locking forms light yet sturdy construction for frame and legs.
- ▶ Height adjustable in increments of 15 cm, starting at 5 cm.
- ▶ Matte White D: vinyl film; gain 1.0 and viewing angle 50° L/R. Seamless until 4.8 m wide.
- ▶ Da-Tex rear projection screen fabric: translucent, grey vinyl; gain 1.8 and viewing angle 30° L/R. Seamless until 4.8 m wide.
- ▶ Projection screen fabrics satisfy the requirements for fire resistance of construction materials and components.



Aspect ratio	Screen size h x w cm	Viewing size h x w cm	Nominal diagonal		Net weight in kg	Screen fabrics		(B) Min. height in cm	(C) Max. height in cm	Separate screen fabric	
			cm	inches		Matte White D prod.code	Da-Tex prod.code			Matte White D prod.code	Da-Tex prod.code
1:1	213x213	203x203			22	10530074	10530073	218	348	10530002	10530012
	244x244	234x234			24	10530083	10530082	249	379	10530004	10530015
	274x274	264x264			25	10530100	10530101	279	409	10530024	10530025
	305x305	295x295			30	10530085	10530084	310	485	10530007	10530018
	366x366	356x356			37	10530092	10530091	371	546	10530009	10530019
3:2	213x320	203x310			28	10530077	10530076	218	348	10530005	10530016
	160x213	150x203	254	100	21	10530069	10530067	165	295	10530001	10530011
4:3	183x244	173x234	305	120	23	10530071	10530070	188	318	10530003	10530013
	228x305	218x295	381	150	28	10530080	10530079	233	363	10530006	10530017
	274x366	264x356	457	180	31	10530096	10530099	279	409	10530022	10530026
	320x427	310x417	508	200	36	10530089	10530087	325	500	10530010	10530020
	142x244	132x234	269	106	35	10530236	10530240	147	277	10530244	10530248
16:9	157x274	147x264	302	119	36	10530237	10530241	162	292	10530245	10530249
	175x305	165x295	338	133	39	10530238	10530242	180	310	10530246	10530250
	211x366	201x355	404	159	41	10530239	10530243	216	346	10530247	10530251

The diagonal sizes listed are approximate in accordance with the market standard. For advice regarding the right size and screen fabric see page 4-6 or consult the Screen Selector at www.projectascreens.com.